



Hello

Thanks for reaching out about the rooftop!

We have a handful of beer garden tables up on the roof that are available for booking (if you don't want to take your chances walking in). Also, if your event must happen rain or shine, you can arrange an insurance hold on one of our indoor spaces as your inclement weather back up plan.



*Randolph*

## THE ROOFTOP

BOOKING A TABLE



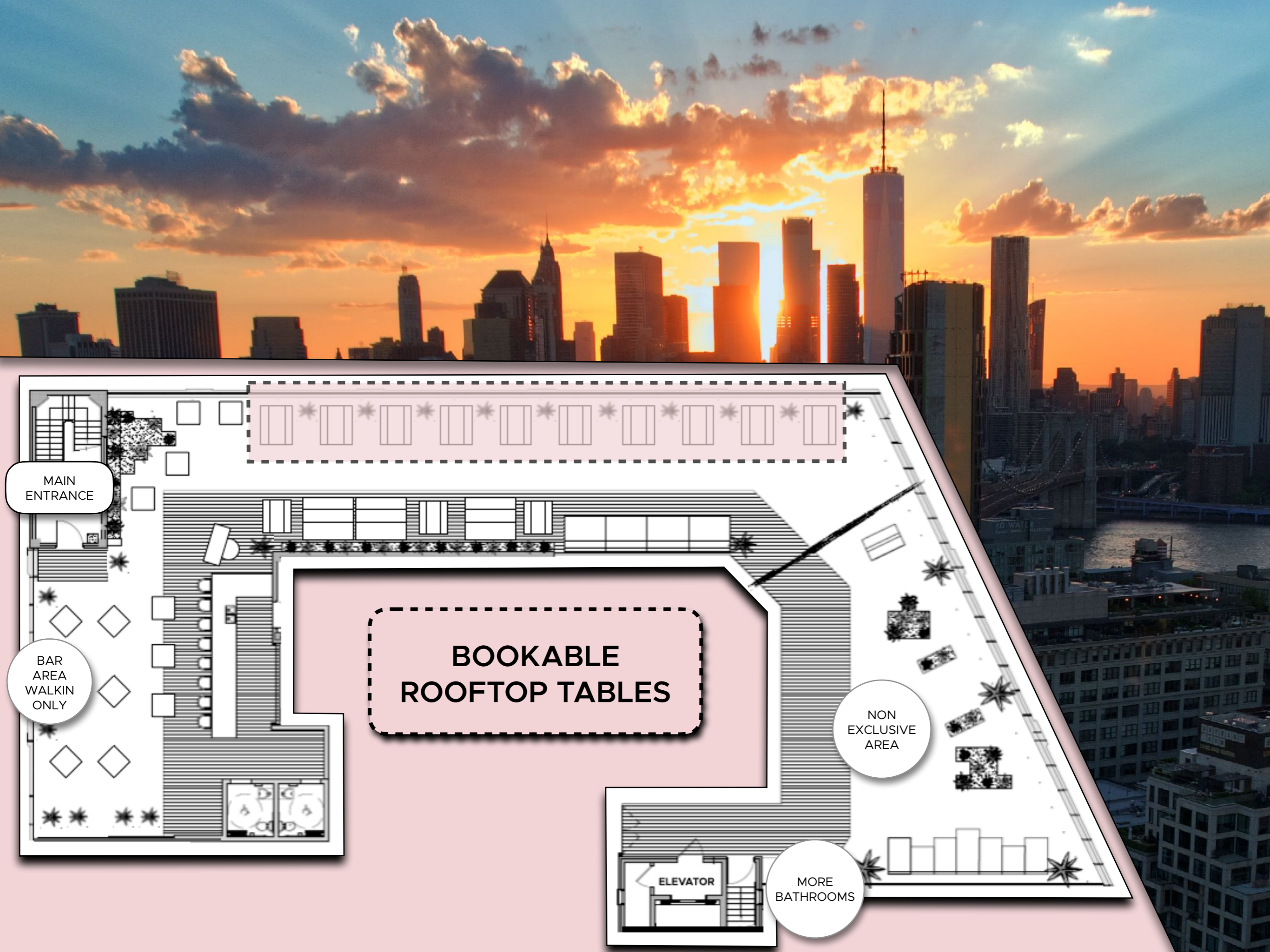

MAIN  
ENTRANCE

BAR  
AREA  
WALKIN  
ONLY

BOOKABLE  
ROOFTOP TABLES

NON  
EXCLUSIVE  
AREA

ELEVATOR

MORE  
BATHROOMS



# ROOFTOP TABLE

UP TO 10 PPL

BEER GARDEN TABLES POSITIONED AGAINST THE GLASS RAILING FACING MANHATTAN ACROSS THE EAST RIVER

## GOOD FOR:

GROUPS THAT WANT TO RESERVE A HOME BASE ON THE ROOFTOP WITH UNOBSTRUCTED, PHENOMENAL VIEWS

**\$375 = 3HR BOOKING +1 MIXED DRINK TUB**

(5 randolph beers + 5 rubi hard seltzers + 5 archer roose wines)

NO MINIMUM SPENDS OR OTHER REQUIREMENTS.

4 TABLES MAXIMUM PER GROUP





OUR ROOFTOP IS ALL OUTDOORS

DURING RAIN AND UNSAFE WEATHER  
CONDITIONS, WE ARE REQUIRED  
TO CLOSE THE ROOFTOP

# INSURANCE HOLD

AVAILABLE FOR ROOF BOOKINGS  
BETWEEN 20 AND 40 PPL

ADD INSURANCE TO TAKE ONE OF OUR INDOOR SPACES OFF THE MARKET  
INCASE THE ROOFTOP CLOSSES DUE TO WEATHER

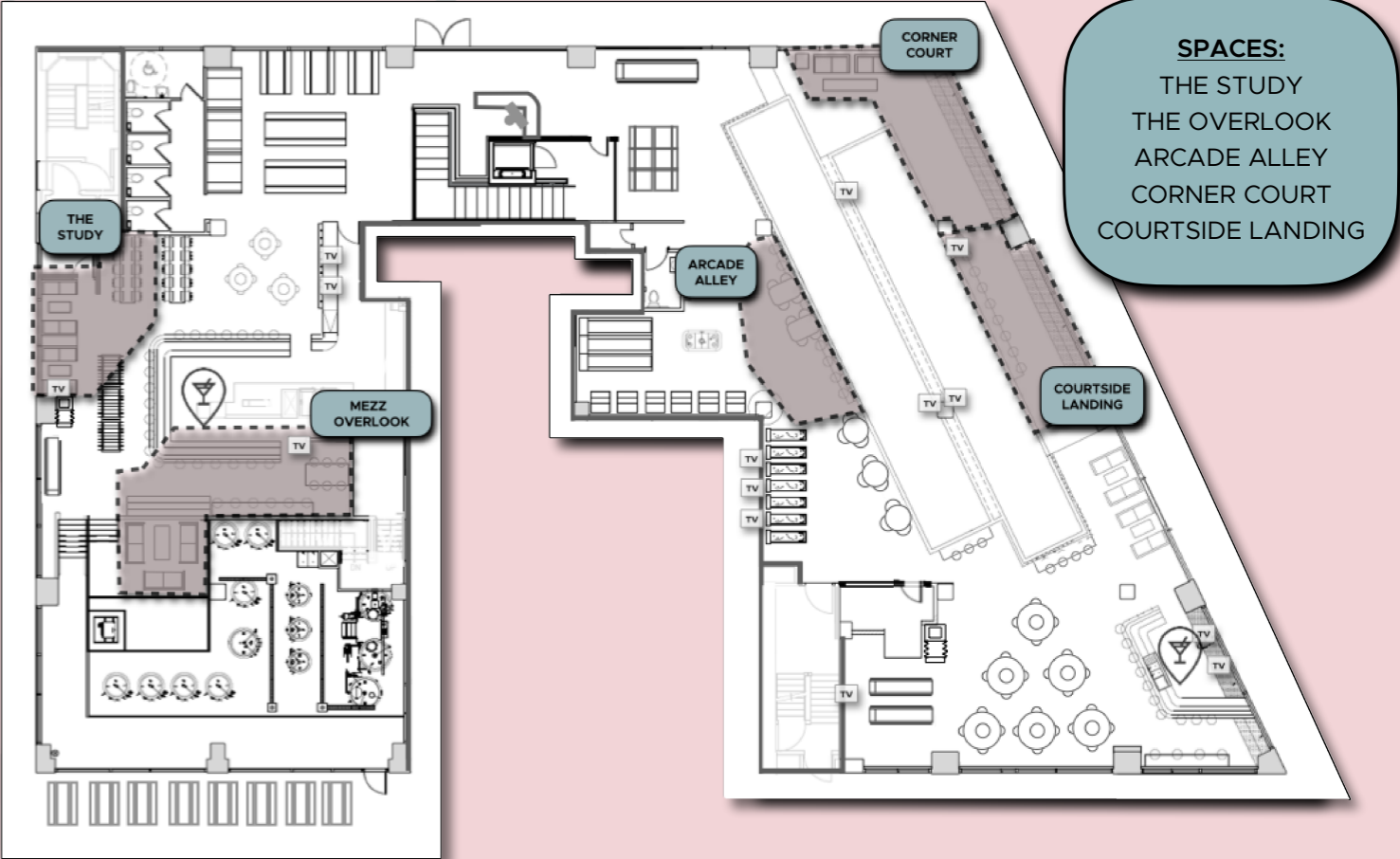

**SPACES:**

THE STUDY  
THE OVERLOOK  
ARCANE ALLEY  
CORNER COURT  
COURTSIDE LANDING

IF YOU END UP INDOORS, THE ROOF TABLE FEE GETS REFUNDED TO YOU,  
LESS THE INDOOR SPACE FEE + THE INSURANCE HOLD

INDOOR SPACE	INSURANCE HOLD	SPACE FEE
THE STUDY (up to 40ppl)	\$200	\$450
OVERLOOK (up to 40ppl)	\$200	\$450
COURTSIDE LANDING (up to 40ppl)	\$175	\$400
CORNER COURT (up to 30ppl)	\$175	\$400
ARCANE ALLEY (up to 30ppl)	\$150	\$300

# INSURANCE HOLD EXAMPLE

---

1. GROUP OF 30 PPL, BOOK 3 ROOF TABLES

2. INSURANCE HOLD ON CORNER COURT

---

***PAID AT BOOKING***

\$1,125 3 ROOF TABLES @ \$375 PER

\$175 INSURANCE HOLD ON CORNER COURT

**\$1,300 TOTAL**

***WEATHER IS GREAT  
EVENT IS ON THE ROOF!***

**\$1,300 TOTAL: ROOF TABLE FEE + INSURANCE**

***ITS RAINING  
EVENT MOVES INSIDE  
TO CORNER COURT***

\$1,300 REFUND ROOF TABLES + INSURANCE

-\$400 LESS: CORNER COURT SPACE FEE

**\$900 AMOUNT REFUNDED**



WE HOPE TO  
SEE YOU SOON!